

FIRST FLOOR

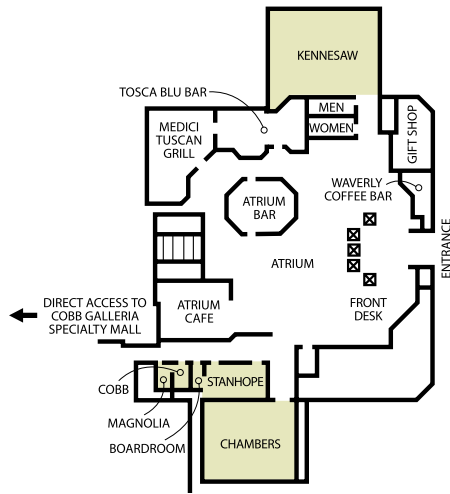

SECOND FLOOR

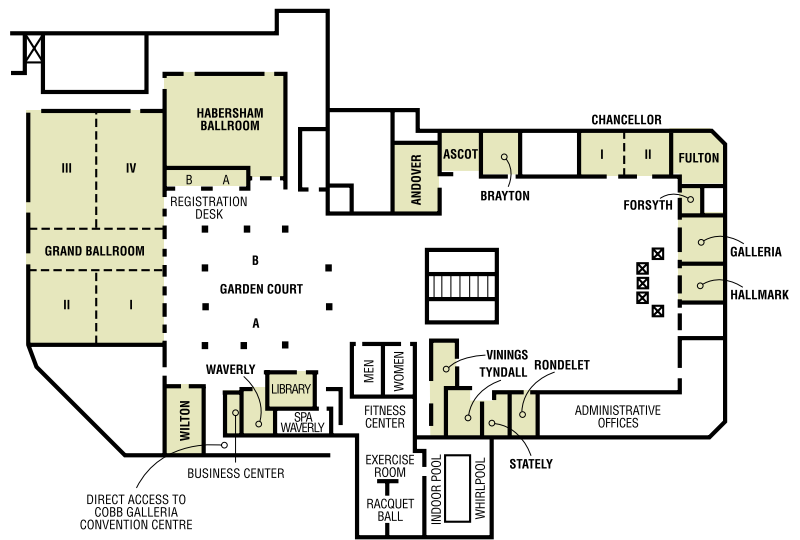

Meeting Room	(WxLxH)	Square Feet	Theater	Schoolroom	Conference	U-Shape	Hollow Square	Reception	Banquet
FIRST FLOOR									
Boardroom	16'x28'x10'	464	Permanent Seating for 12						
Chambers	58'x66'x10'	3,828	Permanent Tiered Seating for 300						
Cobb	15'x34'x10'	525	40	—	20	—	—	30	30
Kennesaw	52'x101'x12'	5,252	350	200	—	65	76	300	250
Magnolia	14'x29'x10'	406	Permanent Seating for 12						
Stanhope	24'x46'x10'	1,104	70	50	36	35	40	100	70
Atrium	—	6,000	—	—	—	—	—	800	500
SECOND FLOOR									
Grand Ballroom	98'x166'x19'	16,268	2,000	1,000	—	—	—	2,000	1,200
Ballroom I & II (each)	49'x55'x19'	2,695	250	150	—	54	66	200	150
Ballroom III & IV (each)	49'x83'x19'	4,067	350	200	—	74	94	350	250
Garden Court	—	14,000	—	—	—	—	—	1,500	800
Habersham Ballroom	67'x88'x19'	5,896	600	300	—	80	100	500	350
Andover	22'x41'x10'	902	50	25	25	25	34	75	50
Ascot	32'x38'x10'	1,216	100	57	30	30	40	100	70
Brayton	27'x32'x10'	864	80	42	24	26	34	75	50
Chancellor	60'x32'x10'	1,920	150	80	—	40	46	150	90
Chancellor I or II (each)	30'x32'x10'	960	75	40	24	26	34	75	40
Forsyth	16'x14'x10'	224	—	—	10	—	—	—	10
Fulton	26'x35'x10'	910	70	40	25	25	34	75	50
Galleria	32'x35'x10'	1,120	110	54	30	29	40	100	60
Hallmark	24'x27'x10'	648	30	25	30	29	28	50	40
Library	18'x23'x10'	414	24	18	20	17	22	30	20
Rondelet & Stately	17'x32'x10'	544	40	20	20	20	18	30	30
Tyndall	24'x32'x10'	768	75	35	24	25	34	50	50
Vinings	17'x10'x10'	170	—	—	10	—	—	—	10
Waverly	25'x37'x10'	925	90	45	30	30	34	75	60
Wilton	28'x45'x10'	1,260	126	75	30	30	46	100	70
Registration A & B (each)	14'x30'x9'	447	—	—	—	—	—	—	—



RENAISSANCE
HOTELS & RESORTS

Renaissance Waverly Hotel

2450 Galleria Parkway | Atlanta, Georgia 30339

t: 770 953 4500 | f: 770 953 0740 | 1 800 Hotels 1 | Renaissancewaverly.com